

INSTALLATION MANUAL



72 WATT OPTIMATCH™ STEREO VOLUME CONTROL SPECIFICATIONS

| | |
|------------------|--|
| Attenuator type: | Tapped auto transformer. |
| Switch: | 12 position rotary, make-before-break contacts, low torque specifications for smooth feel. |
| Connector: | Screw-tight type, or removable. |
| Power rating: | UL Listed @ 72 Watts RMS continuous, 35 Hz- 20 KHz, 216 Watts audio.  |
| Core Saturation: | Studies reveal that transformer core saturation @ 35 Hz is 72 Watts. |
| Transformers: | Tri-filar wound for flat response and minimum phase shift, grain-oriented, -34 dB in 12 steps, 8 steps @ -3 dB each, 1 step @ 4 dB, 1 step @ -6 dB, last step OFF. |
| Mounting: | Fits most standard single gang junction boxes. |
| OPTIMATCH(tm): | Will match impedance for almost any situation. Mechanical index permits presetting load impedance multiplication by X2, X4, X8, X16, X32, X64, etc., which can be changed at any time. |

INSTALLATION

Installation must be made by qualified service personnel, and must meet all local codes.

OPTIMATCH(tm) is a new concept in self-impedance matching controls. It can be used either as a full range volume control, or as an impedance matching volume control that can be adjusted to meet the requirements of your installation. One simple adjustment can be made when the control is connected, and can be changed to accommodate additions to the installation at any time. It is easily retrofitted to almost any existing system.

1. Make connections by stripping the wire insulation back about 3/16". Twist any loose strands tightly.
2. Insert the wires from the amplifier into the INPUT openings of the connector, hot to hot and ground to ground, then tighten the screws. Check for any loose strands that might cause a short circuit. Make sure the metal part of the screw connector engages the bare wire, NOT the insulation.
3. Similarly, connect speaker wires to the control OUTPUT openings and tighten screws.
4. If using the impedance matching feature of the OPTIMATCH(tm) control, set the index following the chart below. To set, remove knob and loosen nut to reposition index. Make sure index is not between detent positions and tighten.
5. Install the control in its operating location. (SUGGESTION: Leave control 3 or 4 positions CCW from maximum before firing up the system for the first time to avoid "blasting" the speakers, while still having enough sound to observe operation.

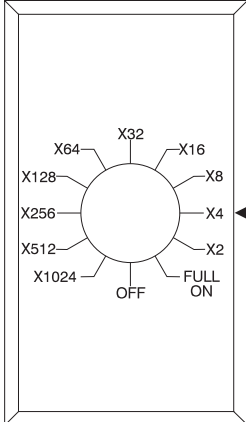
| IMPEDANCE MULTIPLES | #4 Ohm Speakers Per Channel | #8 Ohm Speakers Per Channel | Load (Ohms) | Tap Setting For Matchit(tm) | No. of Available Steps for Optimatch(tm) Controls | |
|---|-----------------------------|-----------------------------|-------------|-----------------------------|---|----|
|  | | 2 | 4.0000 | X2 | 11 | |
| | | | 3 | 2.6667 | X4 | 10 |
| | | 2 | 4 | 2.0000 | X4 | 10 |
| | | | 5 | 1.6000 | X8 | 9 |
| | | 3 | 6 | 1.3333 | X8 | 9 |
| | | | 7 | 1.1429 | X8 | 9 |
| | | 4 | 8 | 1.0000 | X8 | 9 |
| | | | 9 | 0.8889 | X16 | 8 |
| | | 5 | 10 | 0.8000 | X16 | 8 |
| | | | 11 | 0.7273 | X16 | 8 |
| | | 6 | 12 | 0.6667 | X16 | 8 |
| | | | 13 | 0.6154 | X16 | 8 |
| | | 7 | 14 | 0.5714 | X16 | 8 |
| | | | 15 | 0.5333 | X16 | 8 |
| | | 8 | 16 | 0.5000 | X16 | 8 |
| | | | 17 | 0.4705 | X32 | 7 |
| | 9 | 18 | | | | |
| | 16 | 32 | 0.2500 | X32 | 7 | |

© 1999 - 4/20/99

We do not recommend wiring more than 12 Optimatch(tm) controls in parallel (NOTE: Do not run more than (2)-8 Ohm speakers per channel). In these instances more impedance protection should be inserted before the volume controls. The OC-12 is a good choice in this case.

WARRANTY

Your AUDIOPLEX TECHNOLOGY® Stereo Speaker Volume Control is covered by a Lifetime warranty against any defects in workmanship and materials. Any defects will be remedied without charge for labor or parts.

Damage incurred by shipping or accident is not considered to be a defect, and not covered by this warranty. AUDIOPLEX TECHNOLOGY® is not responsible for defective operation caused by abuse or by modification or service by any unauthorized person or agency.

The product must be properly installed and operated according to instructions for the warranty to apply. Any necessary servicing must be done by AUDIOPLEX TECHNOLOGY®. The product must be returned expenses prepaid, with written authorization from the company. The product must be shipped with the proof of purchase and in the original carton and packing material to avoid damage. This warranty gives you specific legal rights. you may have other rights which vary from state to state.

WIRING DIAGRAM

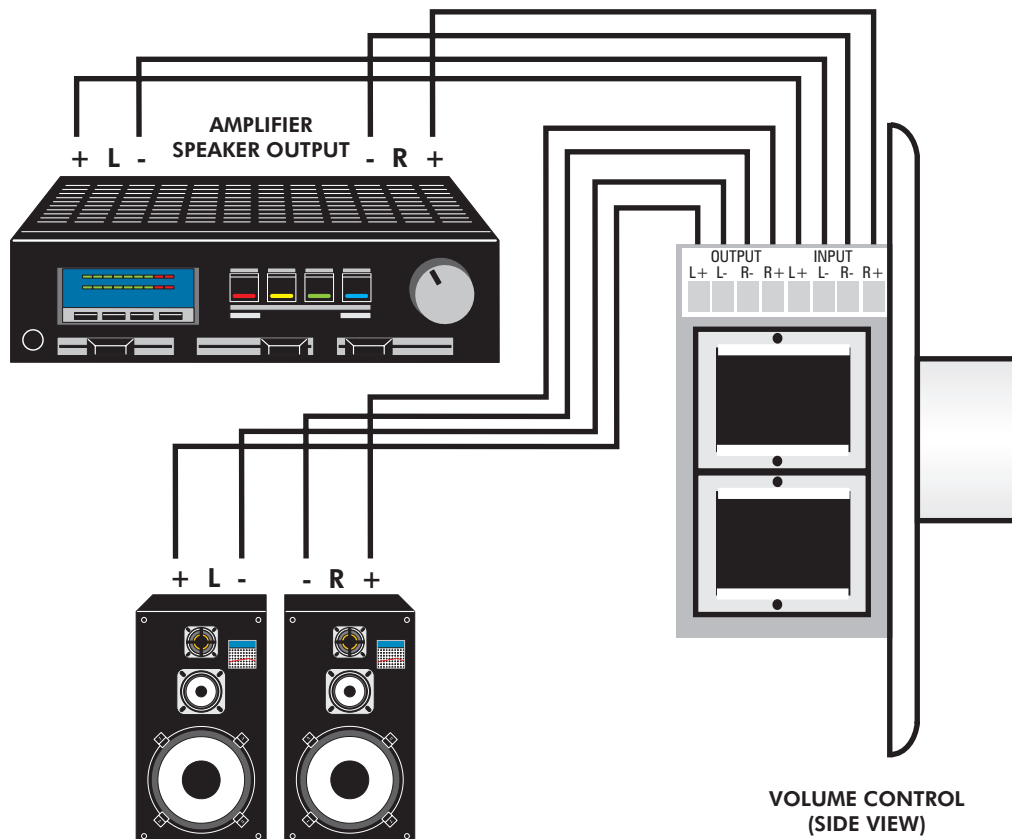

© 1999 - 4/20/99

AUDIOPLEX TECHNOLOGY®

404 GWH P.O. BOX 440
MELVIN VILLAGE, N.H. 03850
1-800-257-2077 1-603-544-8601 FAX: 1-603-544-8901
E-MAIL: audioplex @ conknet.com

INSTALLATION MANUAL



72 WATT OPTIMATCH™ MONO VOLUME CONTROL SPECIFICATIONS

| | |
|------------------|--|
| Attenuator type: | Tapped auto transformer. |
| Switch: | 12 position rotary, make-before-break contacts, low torque specifications for smooth feel. |
| Connector: | Screw-tight type, or removable. |
| Power rating: | 72 Watts RMS continuous, 70 Hz- 20 KHz, 216 Watts audio. |
| Core Saturation: | Studies reveal that transformer core saturation @ 35 Hz is 72 Watts. |
| Transformer: | Tri-filar wound for flat response and minimum phase shift, grain-oriented, -34 dB in 12 steps, 8 steps @ -3 dB each, 1 step @ 4 dB, 1 step @ -6 dB, last step OFF. |
| Mounting: | Fits most standard single gang junction boxes. |
| OPTIMATCH(tm): | Will match impedance for almost any situation. Mechanical index permits presetting load impedance multiplication by X2, X4, X8, X16, X32, X64, etc., which can be changed at any time. |

INSTALLATION

Installation must be made by qualified service personnel, and must meet all local codes.

OPTIMATCH(tm) is a new concept in self-impedance matching controls. It can be used either as a full range volume control, or as an impedance matching volume control that can be adjusted to meet the requirements of your installation. One simple adjustment can be made when the control is connected, and can be changed to accommodate additions to the installation at any time. It is easily retrofitted to almost any existing system.

1. Make connections by stripping the wire insulation back about 3/16". Twist any loose strands tightly.
2. Insert the wires from the amplifier into the INPUT openings of the connector, hot to hot and ground to ground, then tighten the screws. Check for any loose strands that might cause a short circuit. Make sure the metal part of the screw connector engages the bare wire, NOT the insulation.
3. Similarly, connect speaker wires to the control OUTPUT openings and tighten screws.
4. If using the impedance matching feature of the OPTIMATCH(tm) control, set the index following the chart below. To set, remove knob and loosen nut to reposition index. Make sure index is not between detent positions and tighten.
5. Install the control in its operating location. (SUGGESTION: Leave control 3 or 4 positions CCW from maximum before firing up the system for the first time to avoid "blasting" the speakers, while still having enough sound to observe operation.

| IMPEDANCE MULTIPLES | #4 Ohm Speakers | #8 Ohm Speakers | Load (Ohms) | Tap Setting For Matchit(tm) | No. of Available Steps for Optimatch(tm) Controls | |
|---------------------|-----------------|-----------------|-------------|-----------------------------|---|----|
| | | 2 | 4.0000 | X2 | 11 | |
| | | | 3 | 2.6667 | X4 | 10 |
| | | 2 | 4 | 2.0000 | X4 | 10 |
| | | | 5 | 1.6000 | X8 | 9 |
| | | 3 | 6 | 1.3333 | X8 | 9 |
| | | | 7 | 1.1429 | X8 | 9 |
| | | 4 | 8 | 1.0000 | X8 | 9 |
| | | | 9 | 0.8889 | X16 | 8 |
| | | 5 | 10 | 0.8000 | X16 | 8 |
| | | | 11 | 0.7273 | X16 | 8 |
| | | 6 | 12 | 0.6667 | X16 | 8 |
| | | | 13 | 0.6154 | X16 | 8 |
| | | 7 | 14 | 0.5714 | X16 | 8 |
| | | | 15 | 0.5333 | X16 | 8 |
| | | 8 | 16 | 0.5000 | X16 | 8 |
| | | | 17 | 0.4705 | X32 | 7 |
| | 9 | 18 | | | | |
| | 16 | 32 | 0.2500 | X32 | 7 | |

© 1999 - 4/20/99

We do not recommend wiring more than 12 Optimatch(tm) controls in parallel (NOTE: Do not run more than (2)-8 Ohm speakers per channel). In these instances more impedance protection should be inserted before the volume controls. The OC-12 is a good choice in this case.

WARRANTY

Your AUDIOPLEX TECHNOLOGY® Mono Speaker Volume Control is covered by a Lifetime warranty against any defects in workmanship and materials. Any defects will be remedied without charge for labor or parts.

Damage incurred by shipping or accident is not considered to be a defect, and not covered by this warranty. AUDIOPLEX TECHNOLOGY® is not responsible for defective operation caused by abuse or by modification or service by any unauthorized person or agency.

The product must be properly installed and operated according to instructions for the warranty to apply. Any necessary servicing must be done by AUDIOPLEX TECHNOLOGY®. The product must be returned expenses prepaid, with written authorization from the company. The product must be shipped with the proof of purchase and in the original carton and packing material to avoid damage. This warranty gives you specific legal rights. you may have other rights which vary from state to state.

WIRING DIAGRAM

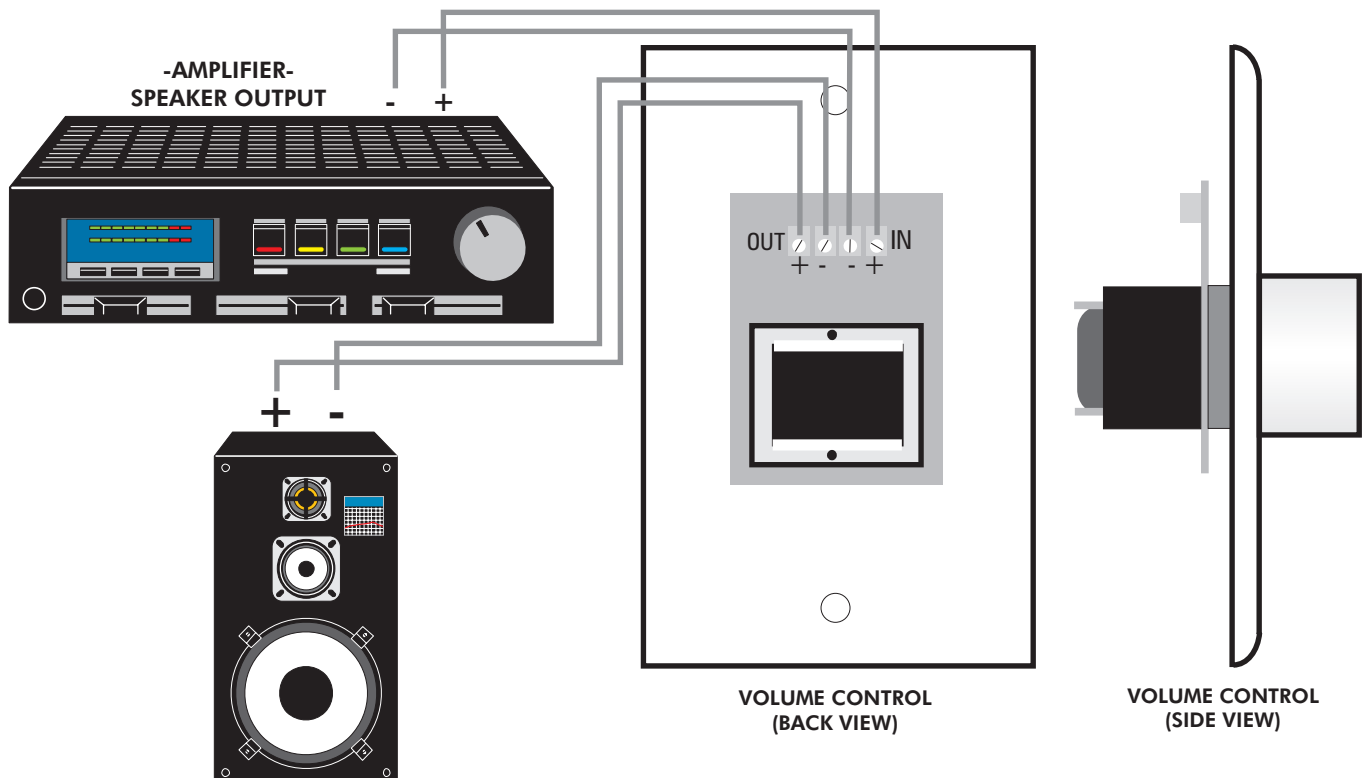

© 1999 - 4/20/99

AUDIOPLEX TECHNOLOGY®

404 GWH P.O. BOX 440
MELVIN VILLAGE, N.H. 03850
1-800-257-2077 1-603-544-8601 FAX: 1-603-544-8901
E-MAIL: audioplex@conknet.com